



POWERED BY

HEATPAX™
 AIR ACTIVATED HEATING

Our HeatPax™ technology is designed to keep your extremities warm in cold conditions. HeatPax™ contains a mixture of ingredients that create heat when exposed to air.

HOW TO USE :

1. Open package to expose HeatPax™ to the air
2. Insert activated HeatPax™ into garment pockets
3. Garment is ready to wear! (HeatPax™ may take about 10 minutes to reach maximum heat)



5540
 Air Activated
 BODY WARMER
5540
 40 Unit Display Case
5540
 240 Unit Bulk Case
 Powered by HeatPax™
 Generates up to
 24+ hours of warmth



5550
 Air Activated
 HAND WARMERS PAIR
5551
 40 Unit Display Case
5552
 240 Unit Bulk Case
5553
 10 Pair Pack
 Powered by HeatPax™
 Generates up to
 10+ hours of warmth



5570
 Air Activated
 TOE WARMERS PAIR
5571
 40 Unit Display Case
5572
 240 Unit Bulk Case
 Powered by HeatPax™
 Generates up to
 6+ hours of warmth



5529S
 Air Activated Heating
 VEST
 Powered by HeatPax™

Colors: Black
 Sizes: S - 3XL
 Includes eight (8)
 HeatPax™ body warmers



5521
 Air Activated Heating
 HARD HAT LINER
 Powered by HeatPax™

Color: Black
 Size: One Size
 Includes two HeatPax™
 Hand warmers (5550)



5526
 Air Activated Heating
 BALACLAVA
 Powered by HeatPax™

Color: Black
 Size: One Size
 Includes two HeatPax™
 Hand warmers (5550)



5503
 Air Activated Heating
 FLEECE GAITER
 Powered by HeatPax™

Color: Black
 Size: One Size



5522S
 Air Activated Heating
 NECK WARMER
 Powered by HeatPax™

Color: Black
 Size: One Size



5519
 Air Activated Heating
 SCARF
 Powered by HeatPax™

Color: Black
 Size: S, M, L
 Includes two HeatPax™
 Hand warmers (5550)



5535
 Air Activated Heating
 SPORT GLOVES
 Powered by HeatPax™

Color: Black
 Size: M/L or L/XL
 Includes two HeatPax™
 Hand warmers (5550)



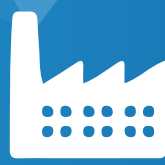

POWERED BY

HYPERKEWL™ PLUS EVAPORATIVE COOLING

HyperKewl™ PLUS Evaporative Cooling material is a unique fabric that absorbs and slowly releases water through evaporation. When the water evaporates, a cooling effect occurs. We look at this process as "super-charging" the body's natural cooling process, thereby helping the wearer to combat heat stress.

HOW TO USE :

1. Soak in water for 1-2 minutes
2. Gently squeeze out excess water
3. Your HyperKewl™ PLUS Item is ready to wear!

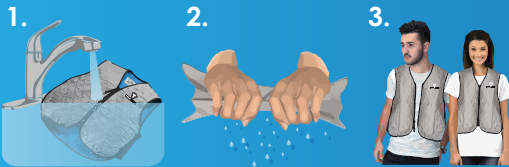

POWERED BY

COOLPAX™ PHASE CHANGE COOLING

CoolPax™ is our Phase Change Material (PCM) cooling technology. It uses a non-toxic carbon-based liquid that freezes at 58°F/14°C and remains at that temperature for 2-3 hours.

HOW TO USE :

1. Simply place CoolPax™ inserts in freezer or ice water for 35/40 minutes
2. Insert activated CoolPax™ into garment pockets
3. Your CoolPax™ Item is ready to wear!



6529

Evaporative Cooling SPORT VEST Powered by HyperKewl™ PLUS

Colors: Black, Silver, Blue, Hi Viz Lime, Khaki, Custom & Fire Resistant Orange
Adult: XS - 3XL, Custom



6538

Evaporative Cooling TRAFFIC SAFETY VEST Powered by HyperKewl™ PLUS

Colors: Hi-Viz Lime & Hi-Viz Orange
Sizes: L/XL , 2XL/3XL



6591

Evaporative Cooling RANGER CAP Powered by HyperKewl™ PLUS

Colors: Hi Viz & Khaki
Sizes: S/M, L/XL, 2XL/3XL



6525

Evaporative Cooling NECKSHADE Powered by HyperKewl™ PLUS

Colors: Hi-Viz Lime, Custom (also available in Fire Resistant Orange)
Sizes: One



6626

Phase Change Cooling VEST Powered by CoolPax™

Colors: Blue, Black, & Khaki
Sizes: M/L (100-175lbs) , L/XL (175-250lbs), 2XL (250-300lbs), Custom
Includes one set of four 6665V CoolPax™ Inserts & a cooler carrying bag
*Also Available in Nomex™ and Banwear™



6626LT

Phase Change Cooling LITE VEST Powered by CoolPax™

Colors: Black
Sizes: M/L, L/XL, 2XL
Includes one set of four 7065V CoolPax & cooler carrying bag



6626HV

Phase Change Cooling ANSI CLASS II HI VIZ VEST Powered by CoolPax™

Colors: Hi-Viz Lime
Sizes: M/L (100-175lbs) , L/XL (175-250lbs), 2XL (250-300lbs)
Includes one set of four 6665V CoolPax & cooler carrying bag



ANSI CLASS II

4531

HYBRID Sport Vest Powered by HyperKewl™ and CoolPax™

Colors: Blue, Black, Silver
Size: S - 3XL, Custom



6622

Phase Change CROWN COOLERS Powered by CoolPax™

Color: Blue
Sizes: One Size
Includes one 6664 CoolPax™ Insert

